

SPECTRE 3.0

SPECTRE 3.0
INTEGRA-M

Dual Loop Side Panel



Assembly Manual

Revision 1.1

Table of Contents

Introduction	2
Spectre 3.0 Dual Loop Side Panel & Dual loop Side Panel Dark	2
Spectre Integra-M Dual Loop Side Panel & Dual loop Side Panel Dark	2
Specifications.....	4
Assembly Manual	5
Step 1.....	5
Step 2	5
Liquid Cooling System Layout	6

Introduction

Spectre 3.0 Dual Loop Side Panel & Dual loop Side Panel Dark

The Spectre 3.0 Dual Loop Side Panel is an addon for any version of Spectre 3.0 including all limited editions and Spectre 3.0 Integra. Essentially it is a mirror image of the main distribution plate, but with some port location and design changes to allow for one loop for the CPU, and one for the GPU/s. It is a replacement for the side panel window and mounts directly onto the side panel window mounts, along with an extra stand-off which attaches to the rear IO panel. It is designed to be as open as possible so that you can still see the most important parts of the build. The distribution plate section only really covers the sides of the radiators and fans which is like traditional windowed case side panels. It has a removable side panel, so it is easy to gain access to the case for loop building. It has an integrated D5 pump top, Protium 2.0 Pump Cover and two ARGB LED strips which come pre-installed. There are 4 ports which are positioned for the GPU loop and top radiator, and a fill and drain port. The main distribution plate layout works perfect for the CPU loop connected to the front radiator. The Spectre 3.0 Dual Loop Side Panel can be used in dual loops, single loop series or parallel, there are many options.

We have created two versions. The Spectre 3.0 Dual Loop Side panel is designed for the non-limited versions of Spectre 3.0 and is built from clear acrylic. The Spectre 3.0 Dual Loop Side Panel Dark is designed for the limited-edition versions of Spectre 3.0 and has a 3mm Satin Black acrylic cover which is removable, a clear acrylic top layer and a grey tinted main rear layer.

The idea for the Spectre 3.0 Dual Loop Side Panel came from one of our customers. We were working on customisation with the customer for his Spectre 3.0 Integra Umbra Limited Edition. He was looking for ways to shroud the radiators and also add dual loops. After going through a few different ideas, we ended up with a concept for a distribution plate which attaches to the side panel window mounts of Spectre 3.0 and adds a second loop. We like to engage with our customers as much as possible to improve our products but this also often leads to inspiration and new ideas.

Spectre Integra-M Dual Loop Side Panel & Dual loop Side Panel Dark

The Spectre Integra-M Dual Loop Side Panel is an addon for any version of Spectre Integra-M including Spectre Integra-MA. Essentially it is a mirror image of the main distribution plate, but with some port location and design changes to allow for one loop for the CPU, and one for the GPU/s. It is a replacement for the side panel window and mounts directly onto the side panel window mounts, along with an extra stand-off which attaches to the rear IO panel. It is designed to be as open as possible so that you can still see the most important parts of the build. The distribution plate section only really covers the sides of the radiators and fans which is like traditional windowed case side panels. It has a removable side panel, so it is easy to gain access to the case for loop building. It has an integrated D5 pump top, Protium 2.0 Pump Cover and two ARGB LED strips which come pre-installed. There are 4 ports which are positioned for the GPU loop and top radiator, and a fill and drain port. The main distribution plate layout works perfect

for the CPU loop connected to the front radiator. The Spectre Integra-M Dual Loop Side Panel can be used in dual loops, single loop series or parallel, there are many options.

We have created two versions. The Spectre Integra-M Dual Loop Side panel is designed for the Spectre 3.0 Integra-M and Integra-MA and is built from clear acrylic. The Spectre Integra-M Dual Loop Side Panel Dark is designed for Spectre Integra-M Dark and has a 3mm Satin Black acrylic cover which is removable, a clear acrylic top layer and a grey tinted main rear layer.

Design & Engineering

We have been building high end water-cooled systems for over 15 years. Our approach to product development begins with a need for our own builds and so the origin is always function. From there we start to build ideas around this function and the aesthetics and everything else follows. The original ideas for our products came from years of building highly customized, high end water-cooled systems and trying to reduce the exceptionally long build times and complexity. Our approach to development is hands on, we are using and testing our own products every day.

Manufacturing & Quality

Almost all of Spectre's components are CNC machined from a solid block of material with extreme precision. Everything is carefully assembled by hand and tested. Our approach and philosophy are that there is no hidden or back side, everything is on display and so the design is a celebration of the raw materials and the manufacturing processes with everything on display.

Specifications

	Spectre 3.0 Dual Loop Side Panel & Dual loop Side Panel Dark	Spectre Integra-M Dual Loop Side Panel & Dual loop Side Panel Dark
Water-cooling Integration	Reservoir, Pump Top, Pump Cover, Fill Port, Drain Port, Parts of water-cooling loop. Ports: x6 G1/4" BSPP. 1x Fill Port. 1x Drain Port. Pump: (Not included): Compatible with all D5 pumps.	
LED Strips	x2 50cm ARGB LED Strips with 50cm cables. (Attach to case panels on specific mounting points for front and top panel glow).	
Package Dimensions L x W x H	536mm x 578mm x 130mm.	
Package Weight	3 kg.	
Product Dimensions L x W x H	486mm x 528mm x 130mm.	479mm x 490mm x 80mm.
Product Weight	3kg	2.5kg
Materials	Cast Acrylic.	
Manufacturing Process	CNC Router.	
Assembly	Distribution Plate Assembled by Hand.	
Testing/Validation	All Distribution Plates are factory pressure tested and precise fastener tension is applied.	
Included Items	<ul style="list-style-type: none"> • Spectre 3.0 Dual Loop Side Panel. • Protium 2.0 D5 Pump Cover. 	<ul style="list-style-type: none"> • Spectre Integra-M Dual Loop Side Panel. • Protium 2.0 D5 Pump Cover.
Compatibility	<ul style="list-style-type: none"> • Spectre 3.0. • Spectre 3.0 Penumbra Limited Edition. • Spectre 3.0 Antumbra Limited Edition. • Spectre 3.0 Arduus. • Spectre 3.0 Arduus Limited Edition. • Spectre 3.0 Integra. • Spectre 3.0 Integra Umbra Limited Edition. • Spectre 3.0 Integra Umbra Chrome Elite Limited Edition. 	<ul style="list-style-type: none"> • Spectre Integra – M.

Assembly Manual

Step 1

The Dual Loop Side Panel attaches just like the standard side panel window except that it has an extra reinforcing stand off which attaches to the Rear I/O Panel.

Attach M3 Stand Off and M3 Nut to Rear I/O Panel using the M3 x 10mm fastener from behind the Rear I/O.

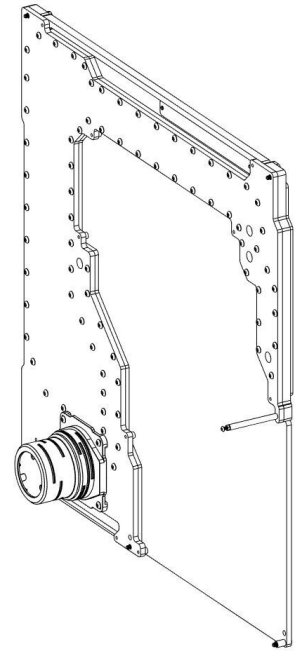
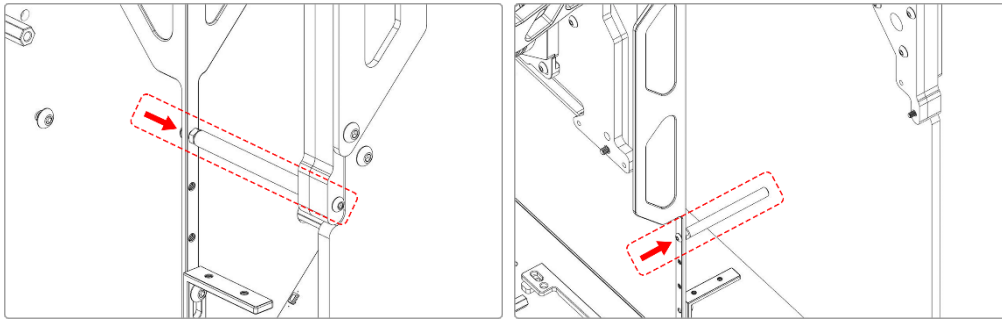

Step 2

The Dual Loop Side Panel can then be installed to the Side Panel Window Mounts and the Rear I/O Stand Off, using the included 4x M4 x 20mm and 1x M3 x 20mm (which is used on the Rear I/O stand off).

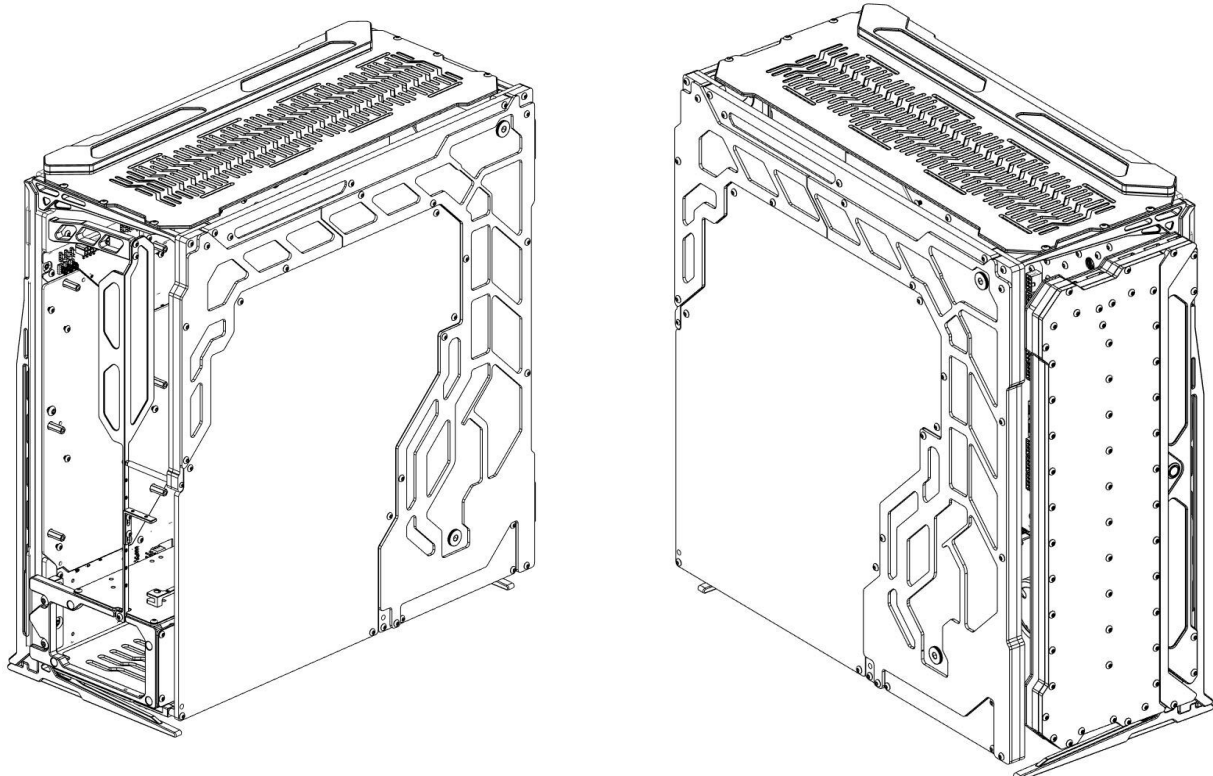

Liquid Cooling System Layout

